



NORDIC BEAST

Golden CAT WHEEL INSTALLATION MANUAL

HINT:

Do not tighten all the mounting screws completely at once. Instead, tighten them again individually after installing and forming each component.

Read the manual once through before starting the assembly.

LAYOUT MATERIALS ■ Product Components

For **video assembly** visit - www.nordicbeast.eu/hello



Ax2

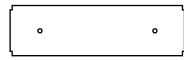

Bx2

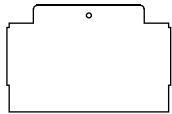

Cx2

* One of them has a screw hole



Dx6



Ex23

* three pieces of E have double holes on the side

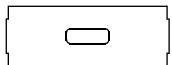

Fx1



Gx2



Hx6



Ix1



Jx4



Kx16



Lx24



Mx70



Nx70



Ox1



Px4

long screw



Qx4



Rx4



Sx1

STEP 01 Install anchor plugs

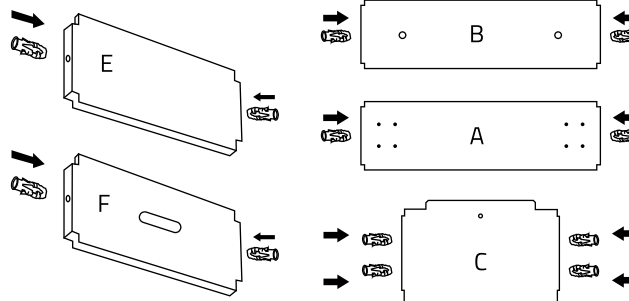

Insert the N yellow anchor plugs into the holes at both ends of the parts A, B, C, E, F



STEP 02 Install the wheels Q to the plate B and the wheels J to the plate A

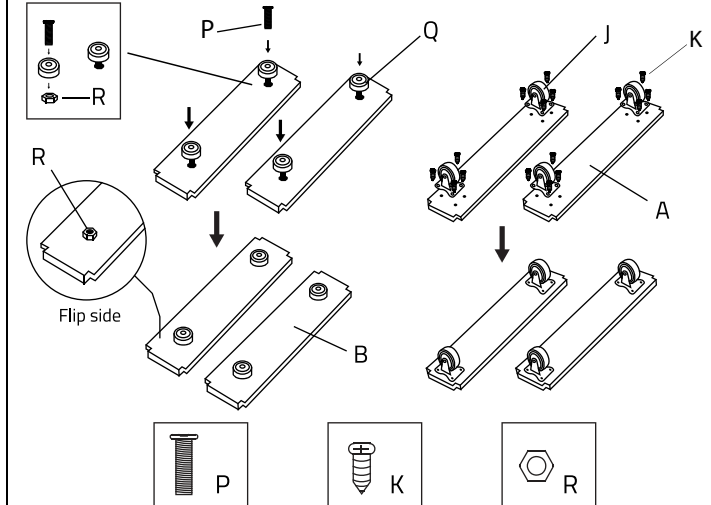

STEP 03 Putting the base of the wheel together

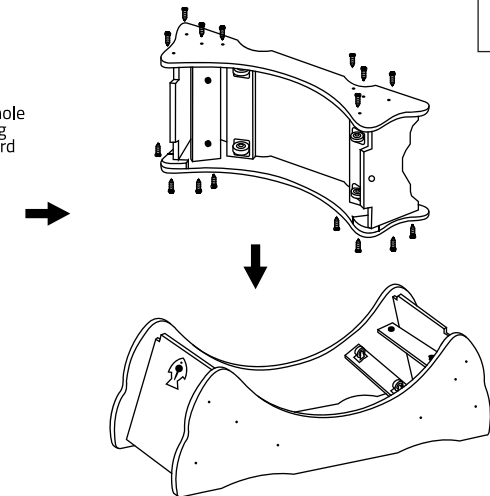
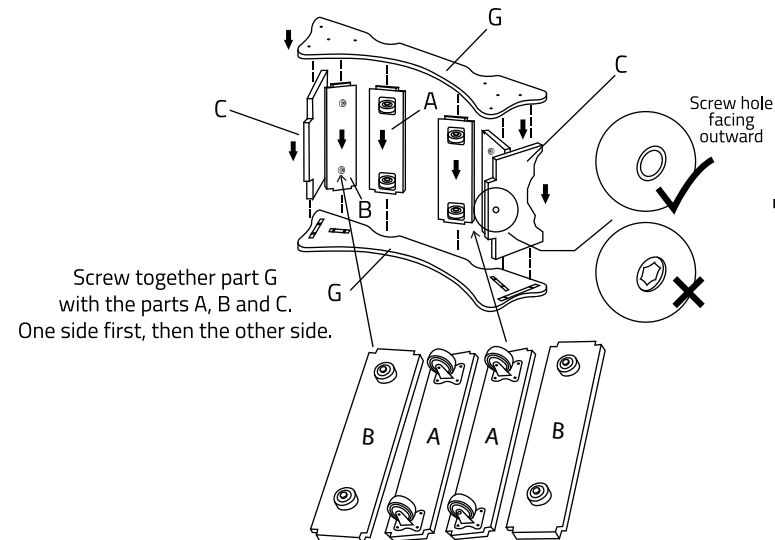

Base Installation Complete

STEP 04 Place part F at a random place

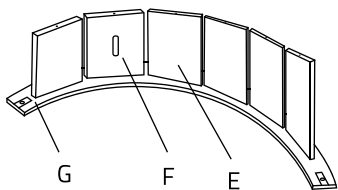

STEP 05 Attach plates E to the arch D using screw M

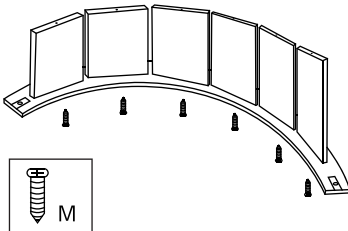

STEP 06 Fix another arch on the opposite side of plates E

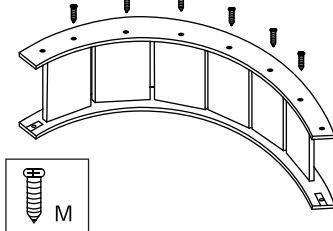

STEP 07 Repeat steps 4-6 until all of the 3 arches are assembled

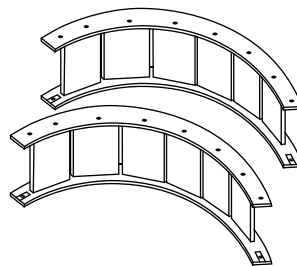

STEP 08 Use the part E (with double screw holes) to connect the arches together

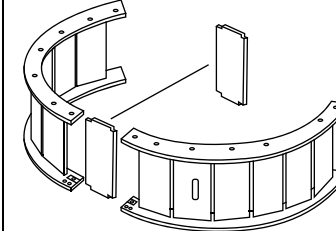

STEP 09 Align the arches before tightening the screws

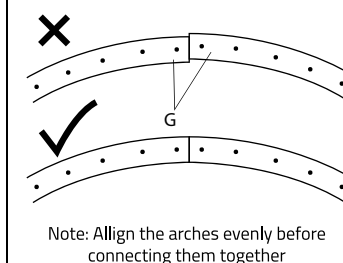

STEP 10 Connecting the arches

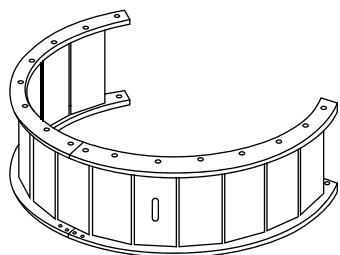

STEP 11 Attach fixators H to the inside curve of the arches with screw L

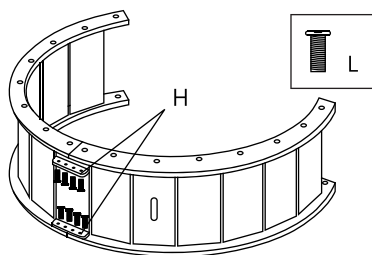

STEP 12 Assemble the wheel together

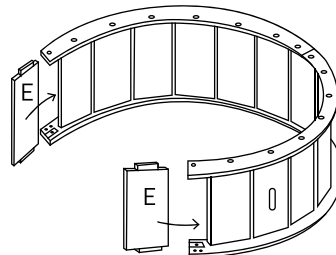

STEP 13 Install the final fixator H

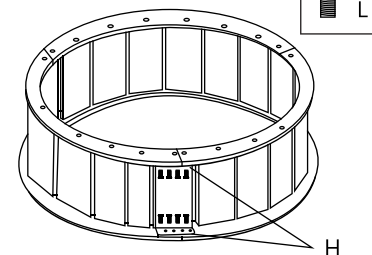

STEP 14 Place the wheel on the base

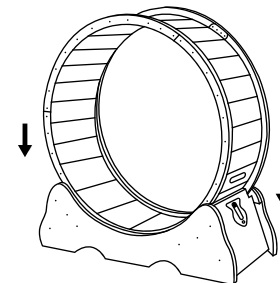

STEP 15 Install the break to the wheel

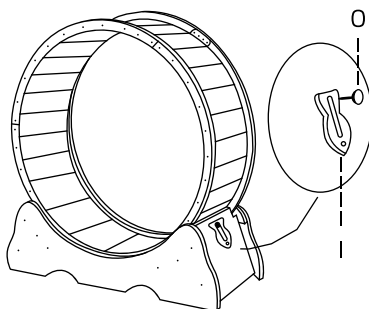

STEP 16 Glue the Velcro to the inside of the treadmill's running area

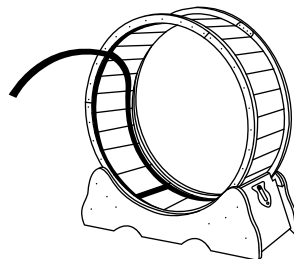

Note: Wipe the running area clean before gluing Velcro

STEP 17 Attach the carpet evenly and tightly to the inside of the runway

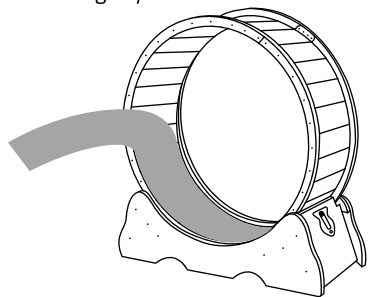

STEP 18 Apply the gold accent strip along the **bold*** lines

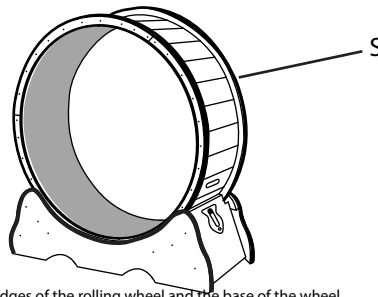

*Inner and outer edges of the rolling wheel and the base of the wheel

Congratulations! You've completed the assembly!

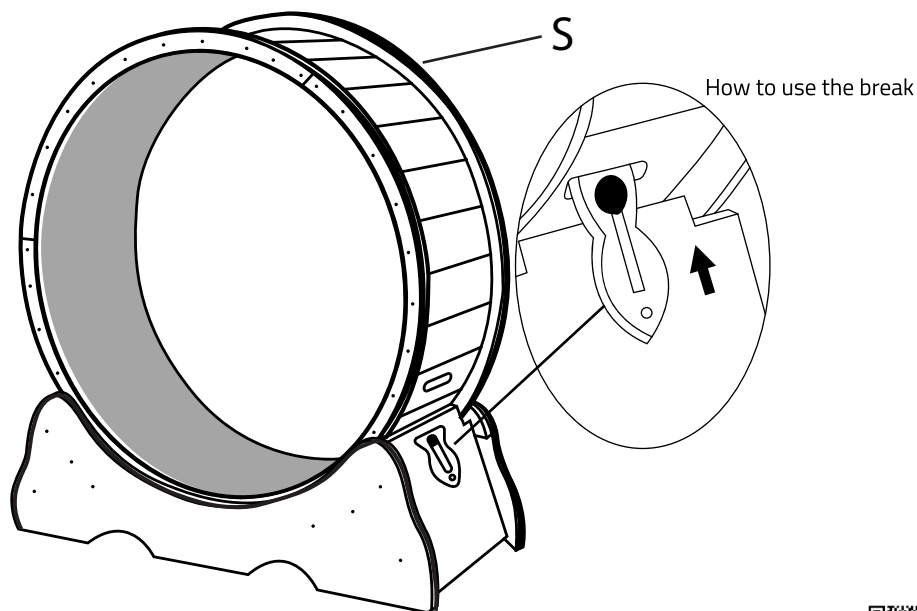

Although we always inspect our products thoroughly, make sure to let us know if there is anything missing!

